

Ritz Flip Table

Ritz Flip Table Installation Guide



T10022

1) Parts and Fasteners Included

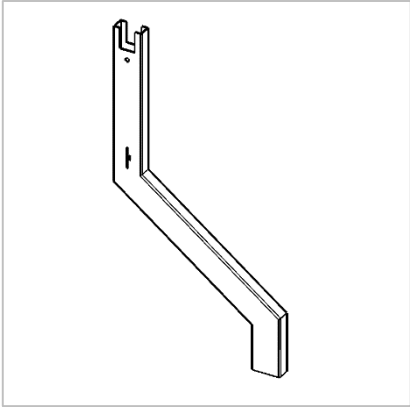

LEG COLUMN
(RZLEGS)

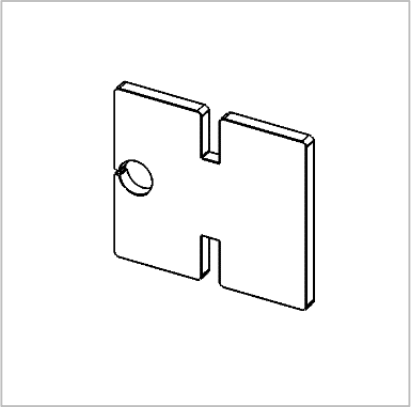

LEG CONNECTION KEY
(RZLEGS)



FRAME SUB ASSEMBLY
(RZNTxxxx)

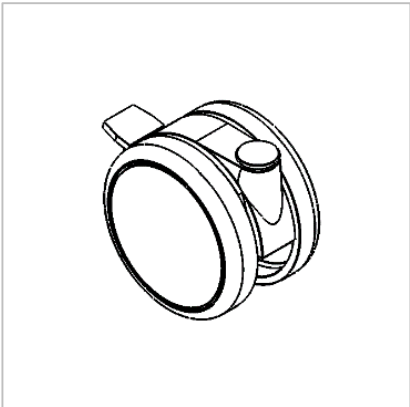

CASTER
(RZCB)

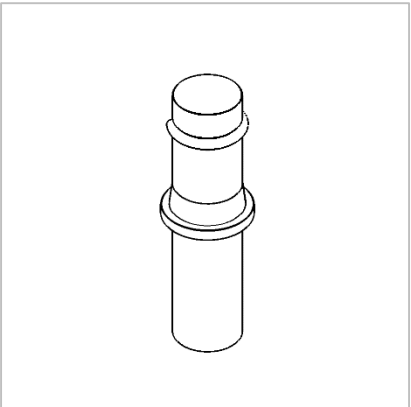

CASTER PIN
(RZCB)

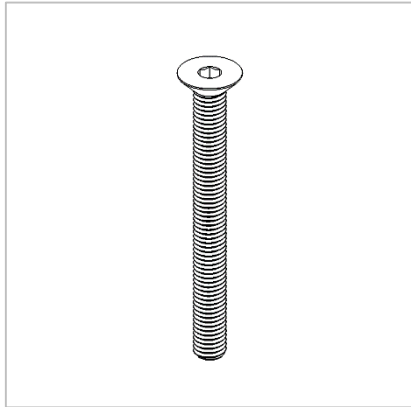

M8-1.25 x 70mm

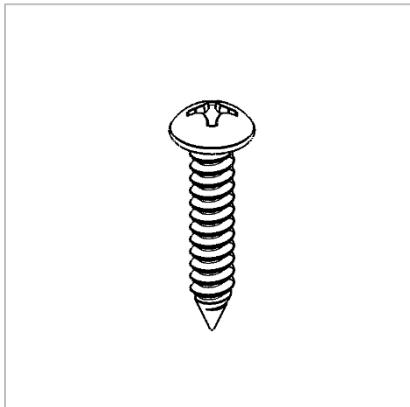

#10 x 1.00" WOOD SCREW

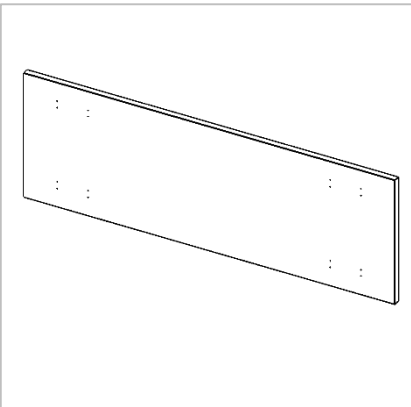

WORKSURFACE
(CRFxxxx)

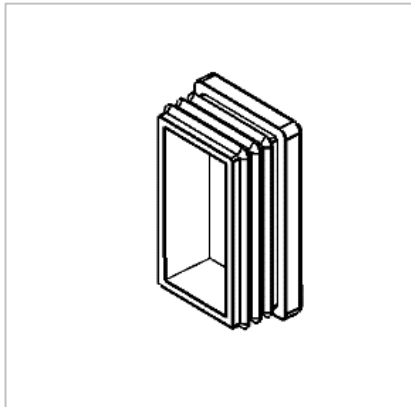

PLASTIC END CAP
(RZEC)

1) Parts and Fasteners Included

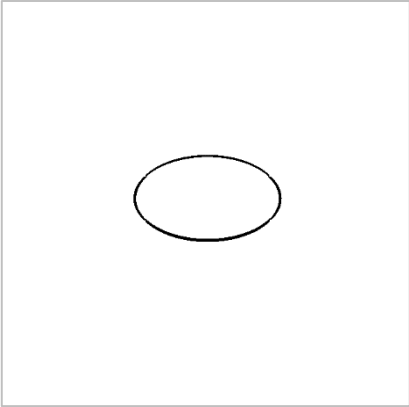

CAP COVER

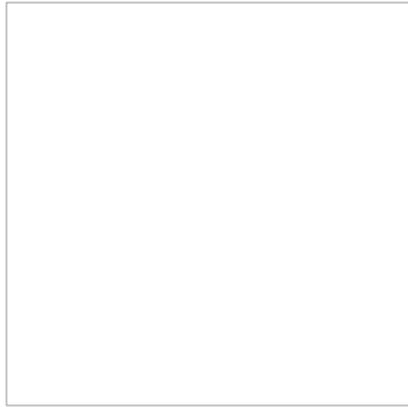
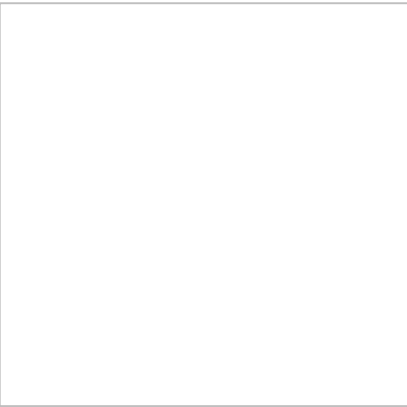
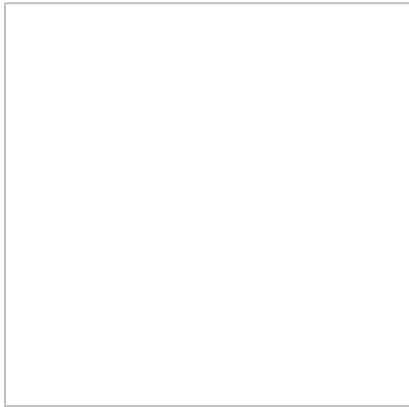
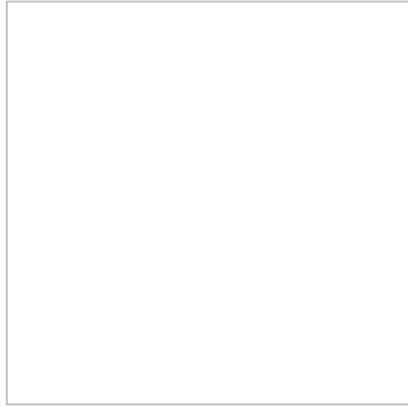
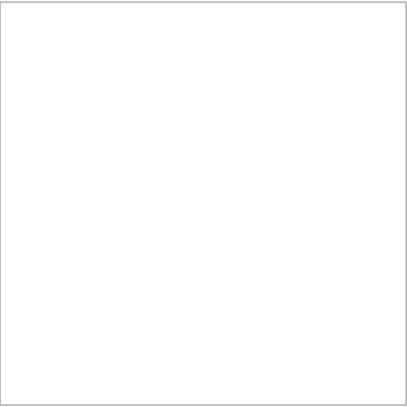
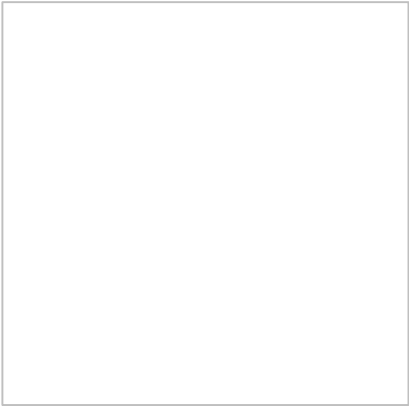
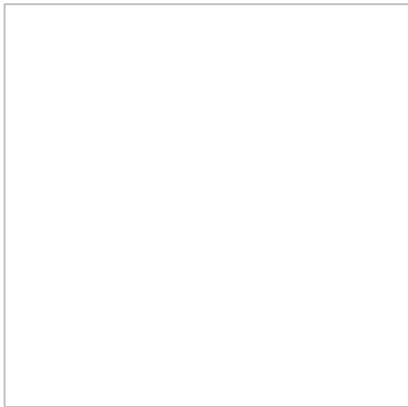
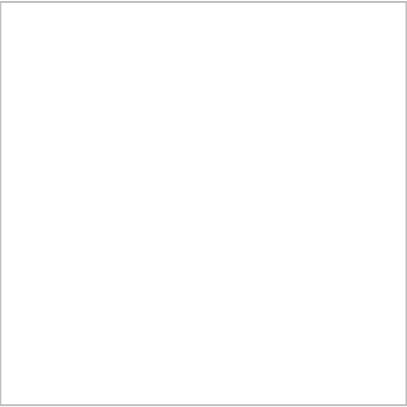

2) Tools and Supplies Required

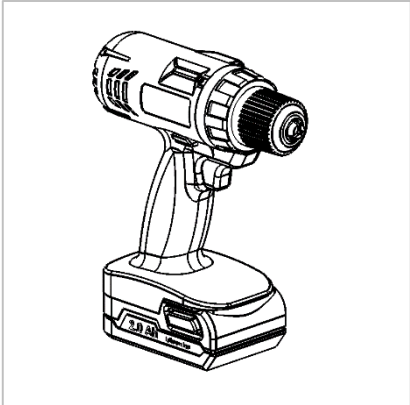

DRILL/DRIVER

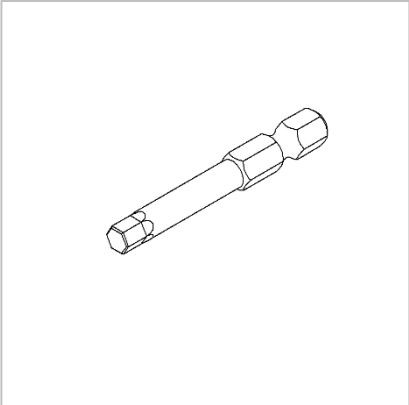

5mm HEX BIT

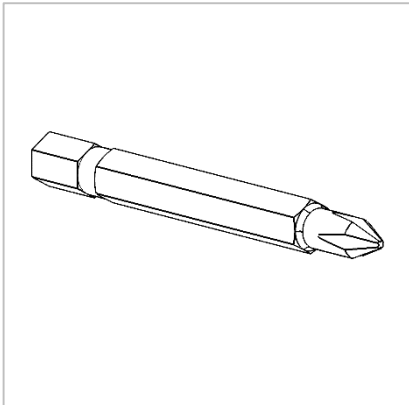

#2 PHILLIPS BIT
(#2 SQUARE BIT OPTIONAL)



HAMMER
(SAND MALLET OPTIONAL)

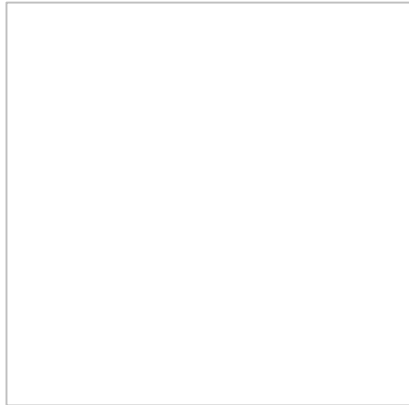
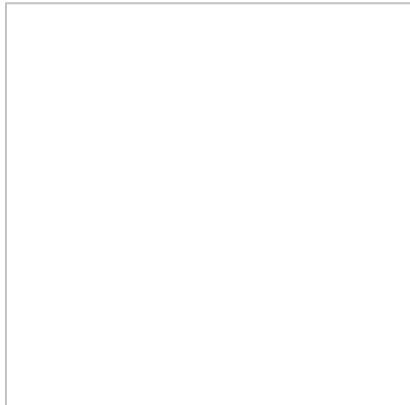
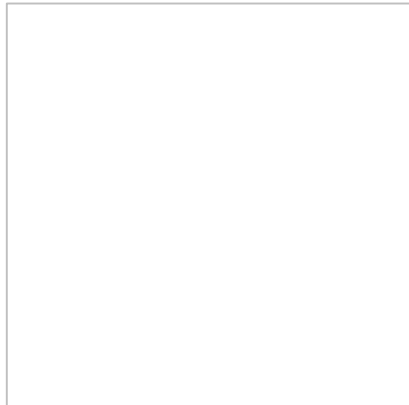
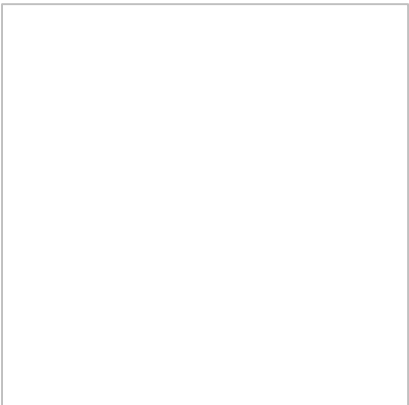

3) Assembly Overview

1. Leg Assembly
2. Leg Attachment
3. Frame Placement
4. Frame Attachment

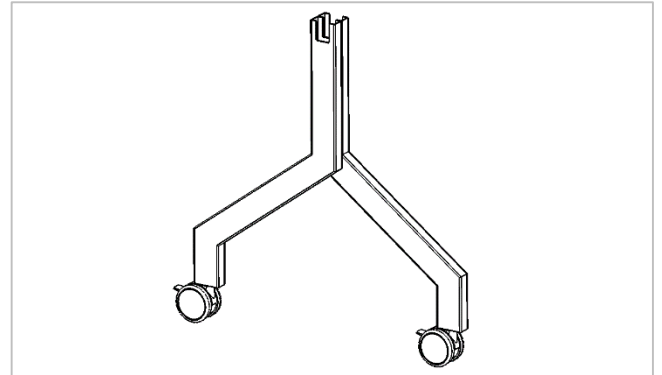

Figure 3.1

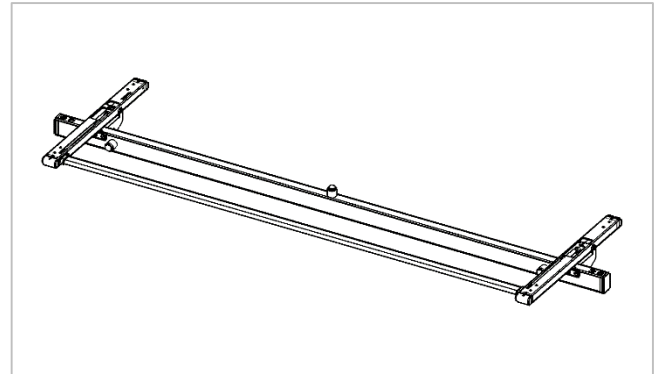

Figure 3.2

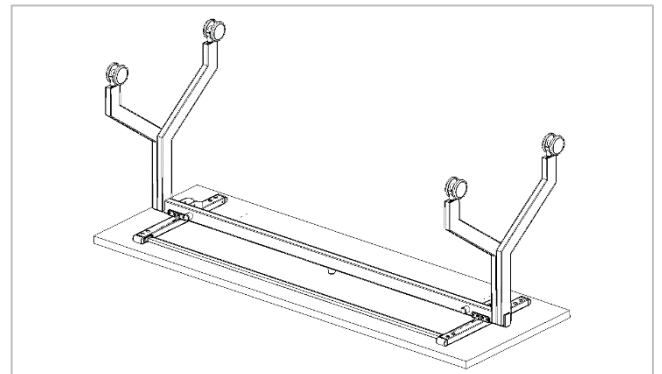

Figure 3.3

4) Assembly: Leg Assembly

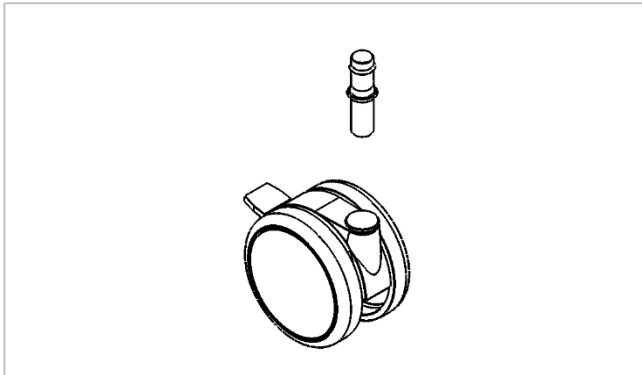

Figure 4.1

- Locate the caster and caster pin.
- Using a hammer, carefully knock the caster pin into the caster until it is completely seated.

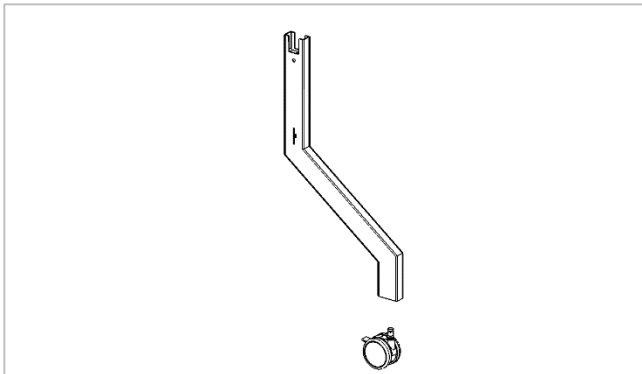

Figure 4.2

- Locate one of the leg columns.
- Firmly press the caster pin into the bottom of the leg column.
- Caster should seat completely in leg and then swivel freely.

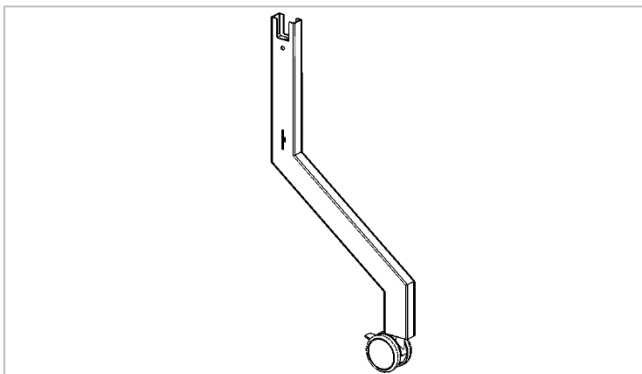

Figure 4.3

- Single Leg assembly shown.
- Repeat these steps for all 4 of the leg columns.

4) Assembly: Leg Assembly (continued)

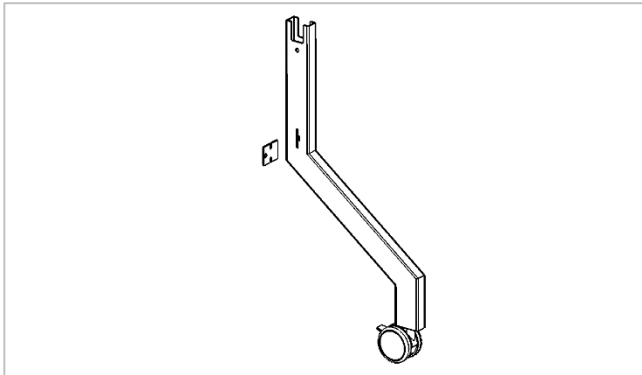

Figure 4.4

- Locate the leg connection key.
- Insert the key into the slot of the single leg.

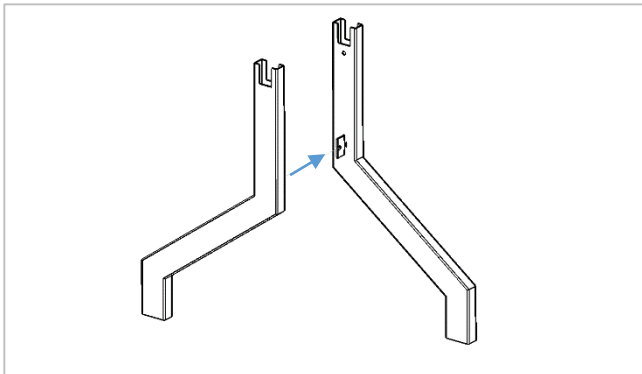

Figure 4.5

- Insert the second leg component onto the other side of the key.
- Slide the second leg up until the tops of the legs are even.
- NOTE: leg components will continue to slide up and down until attached to frame.

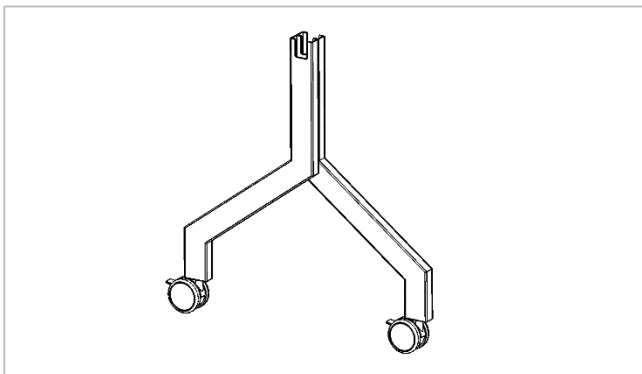

Figure 4.6

- Verify that the key is seated securely in the leg columns by gently pulling the legs apart.
- If there is a gap between the legs, shift the legs vertically until the key is seated properly.
- Complete the above steps for both sets of legs.

4) Assembly: Leg Attachment

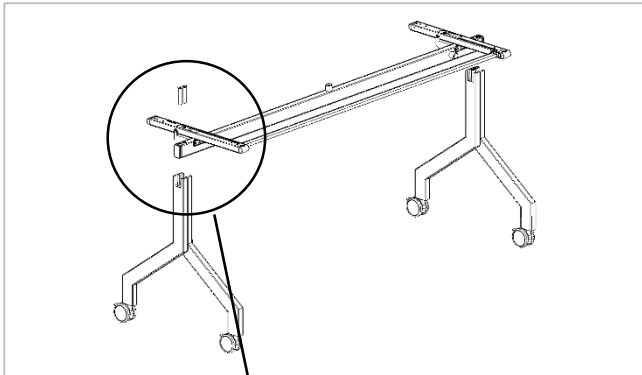

Figure 4.7

- Locate the pre-assembled frame sub-assembly
- Locate the M8 x 70mm Flat head bolts included in the hardware pack.

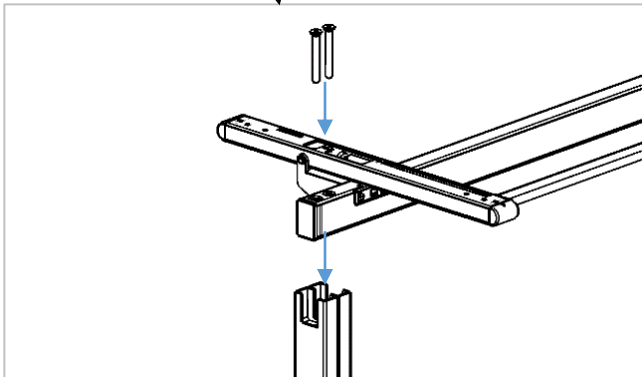

Figure 4.8

- While holding the leg columns together, line up the mounting holes in the legs with the clearance holes in the frame sub assembly.
- Slide the leg columns onto the beam.
- Using the M8 x 70mm bolts, connect the legs to the frame.
- Again, verify that the leg columns are firmly secured together and do not come apart.

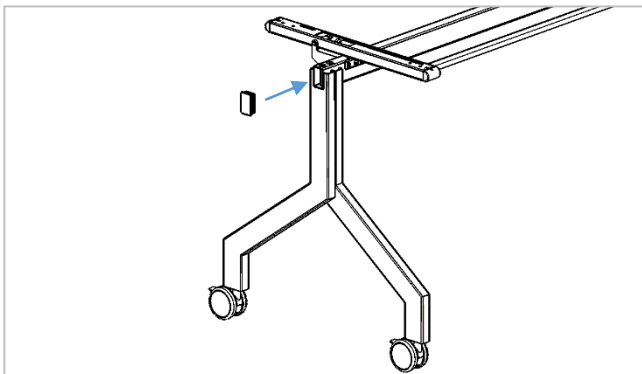

Figure 4.9

- Repeat the above steps for the other set of legs.
- Locate the included black end caps.
- Push in the end caps into the open ends of the beam.

4) Assembly: Frame Placement and Attachment

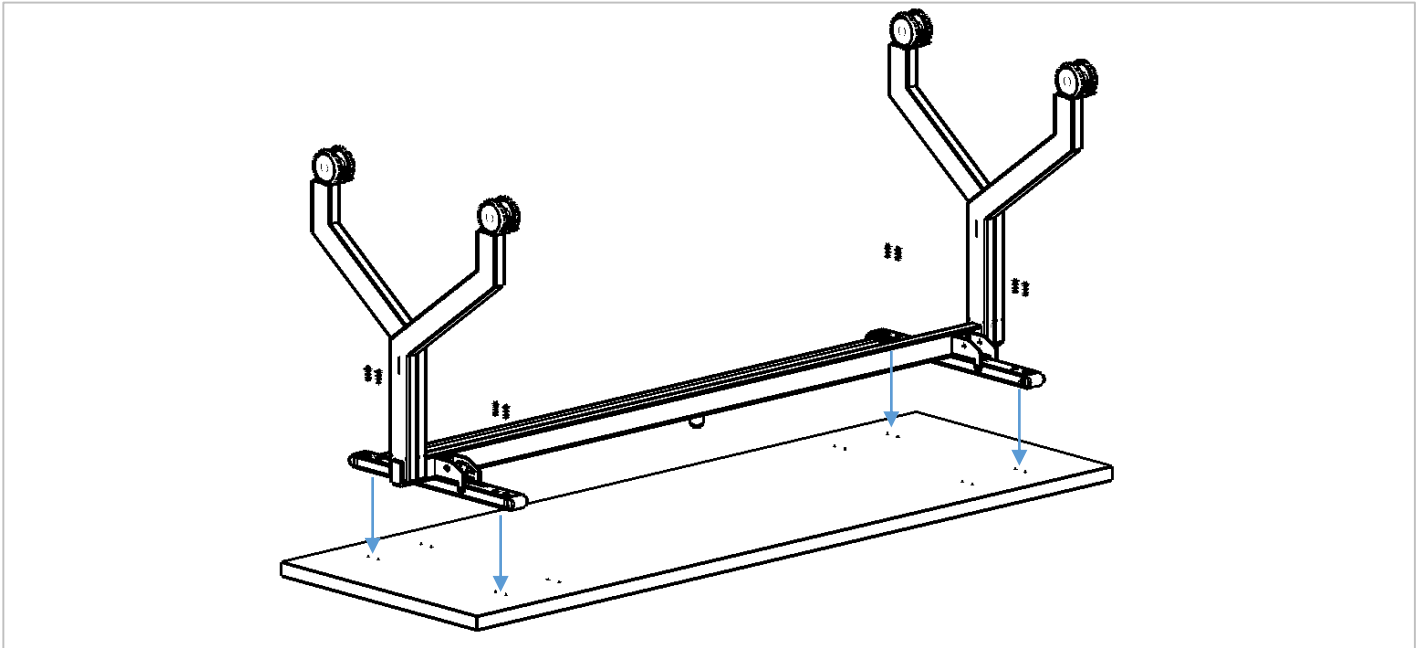

Figure 4.10

- Lay the top face down on a non-marring surface.
- Place the frame on the top with the black flip mechanisms spaced evenly from the sides of the table.
- Line up the holes in the flip mechanisms with the pre-drilled holes in the work surface.
- Attach the frame to the top with the included wood screws.
- Insert the included Cap Covers into the holes in the flip mechanisms to cover the screws.

ENWORK

12900 Christopher Drive Lowell, MI 49331
800.815.7251 www.enwork.com

Specifications subject to change without notice.