



Clamp Privacy Screen

Above Desk Top (Side-to-Side) Installation Instructions

STEP 1

Put screen in clamps and secure with provided bolts.

Note: Please use the correct bolt for your panel thickness:

Panel Thickness	Bolt Length	Part Number
0 - .55"	25mm	91292A138
.56 - .80"	30mm	91292A139
.81 - 1.05"	35mm	91292A141

Make sure the screen is sitting on a ledge (see image at right) to get proper tension.

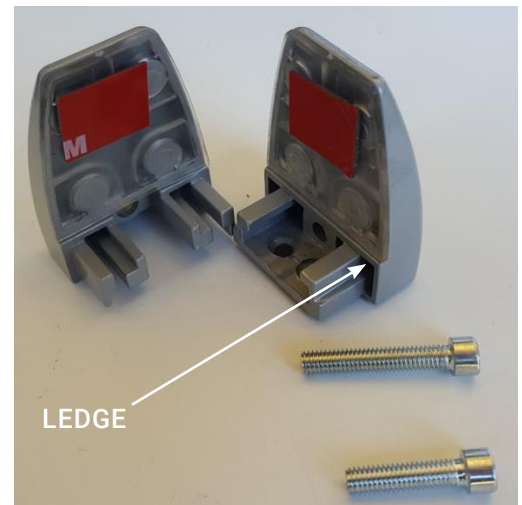

STEP 2

Remove double stick tape release paper (if desired). Place screen into position on top – the front clamp wraps around worksurface and the rear clamp sits on top of worksurface. Use wood screws (not shown) to secure front bracket to underside of top.

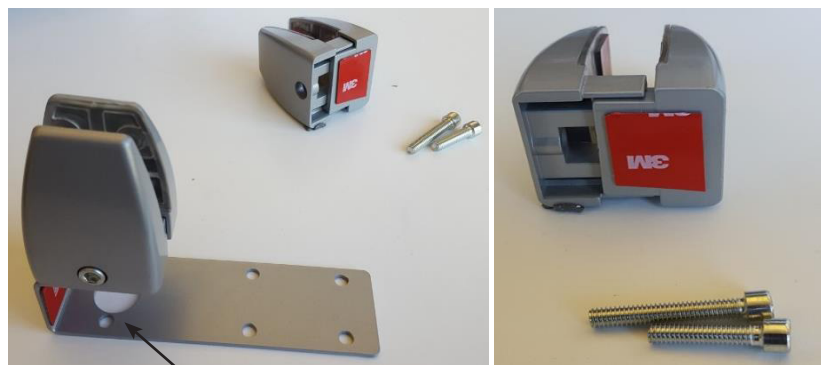

FRONT EDGE OF WORKSURFACE GOES HERE

WARNING:

Acrylic screens scratch and scuff easily. After removing protective film, immediately and carefully install the screen.

DO NOT remove protective film from acrylic screens, then stack them in a pile or against each other. Experience shows this will cause marring and scratching.

1.800.815.7251

www.enwork.com

Specifications subject to change without prior notice.