



Clamp Privacy Screen

Above Desk Top (Side-to-Side) Installation Instructions

STEP 1

Put screen in clamps and secure with bolt.
Note: longer bolt is used with 3/8"+ screens and shorter bolt is used on 1/4" thick screens. MAKE SURE SCREEN IS SITTING ON LEDGE (see right) to get proper tension.

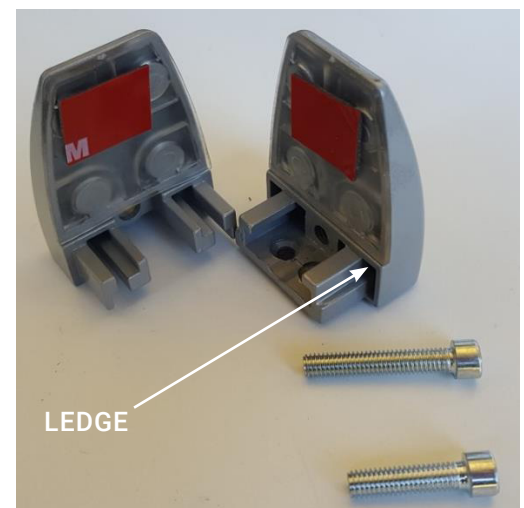

STEP 2

Remove double stick tape release paper (if desired). Place screen into position on top – the front clamp wraps around worksurface and the rear clamp sits on top of worksurface. Use wood screws (not shown) to secure front bracket to underside of top.

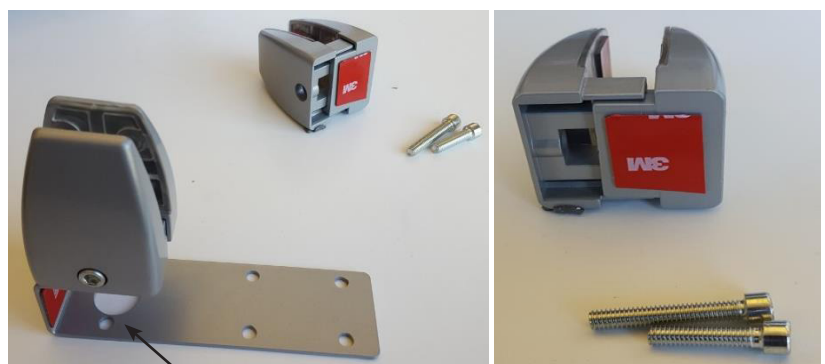

FRONT EDGE OF WORKSURFACE GOES HERE